

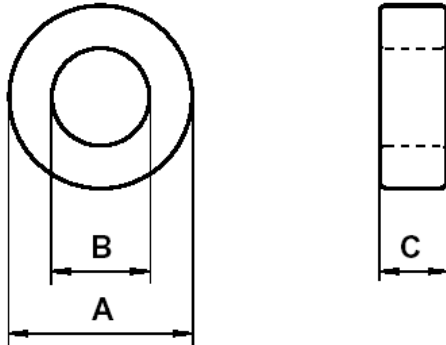

Specification for:
ZP-42915-TC

110 Delta Drive
Pittsburgh, PA 15238
Phone: 412/696-1333
Fax: 412/696-0333
Email:magnetics@spang.com

DIMENSIONS



(mm)	Uncoated Nominal:	Coated Min:	Coated Max:
O.D. (A)	29	28.35	30.15
I.D. (B)	19	17.85	19.65
Ht. (C)	15.2	14.99	16.21

Eff. Parameters		
A _e mm ²	l _e mm	V _e mm ³
74.9	73.2	5481

INDUCTANCE

AL value (nH/T ²)	Test conditions
3222 ± 25%	10 kHz, 0.5 mT (For N = 5, use 1.4 mA), 25°C

CORE LOSSES

P _L max	Production lot limit Max avg	Test conditions
674 mW (123 mW/cm ³)	614 mW (112 mW/cm ³)	100 kHz, 100 mT, 100°C

COATING

Epoxy rated for 200°C continuous operation.
Voltage breakdown rating 2000 V _{DC} Min Wire-to-Wire.

NOTE

Spec. Modifications	Previous	Revised
2005.06.14	OD max = 29.90 ID min = 18.11 Ht max = 16.01 Losses: General P material Breakdown voltage > 1,000 V	OD max = 30.15 ID min = 17.85 Ht max = 16.21 Losses: Detail as indicated Breakdown voltage > 2,000 V _{DC}